

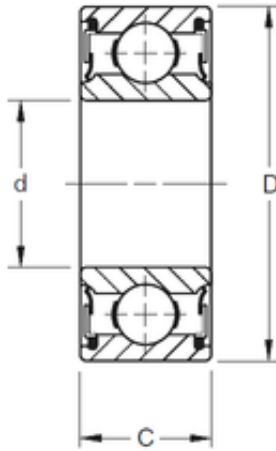

TIMKEN BEARING MFG.CORP



70 mm x 125 mm x 24 mm TIMKEN 214NPP Single Row Ball Bearings

Bearing No. 214NPP

Size	70x125x24 mm
Bore Diameter	70 mm
Outer Diameter	125 mm
Width	24 mm
d	70 mm
D	125 mm
B	24 mm
C	24 mm
Weight	1,107 Kg
Basic dynamic load rating (C)	69 kN

214NPP Bearing 2D drawings and 3D CAD models