

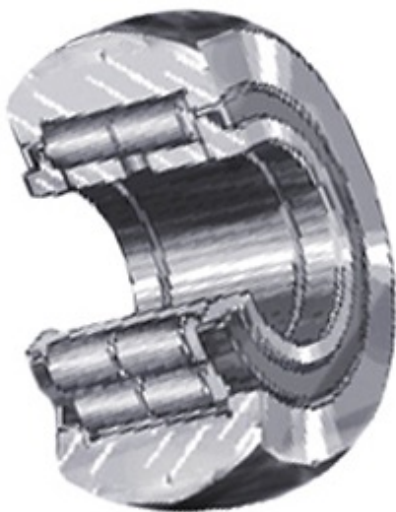

TIMKEN BEARING MFG.CORP



INA NUTR2052 Cam Follower and Track Roller - Yoke Type

Bearing No. NUTR2052

NUTR2052 Bearing 2D drawings and 3D CAD models

Category	Cam Follower and Track Roller - Yoke Type
Inventory	0.0
Manufacturer Name	SCHAEFFLER GROUP
Minimum Buy Quantity	N/A
Weight	0.318
EAN	4012802419467
Product Group	B04120
Roller Surface Profile	Crowned
Profile	Yoke Type
Enclosure	Sealed
Rolling Element	Cylindrical Roller Bearing - Double Row
Relubricatable	Yes
Inch - Metric	Metric
Other Features	Full Complement With Inner Ring Labyrinth Seal
Long Description	20MM Bore; 52MM Roller Diameter; 24MM Roller Width; Crowned Roller; Yoke Type; Sealed; Cylindrical Roller Bearing - Double Row; Relubricatable
Category	Cam Followers Yoke Type
UNSPSC	31171530
Harmonized Tariff Code	8482.50.00.00
Noun	Bearing
Keyword String	Cam Follower



TIMKEN BEARING MFG.CORP

Manufacturer URL	http://www.ina.com
Manufacturer Item Number	NUTR2052
Weight / LBS	0.708
d	0.787 Inch 20 Millimeter
Roller Diameter	2.047 Inch 52 Millimeter
Roller Width	0.945 Inch 24 Millimeter